

FILL-RITE®

A GORMAN-RUPP COMPANY

RD8 SERIES TECHNICAL SPECIFICATIONS

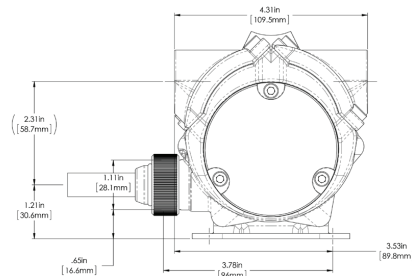
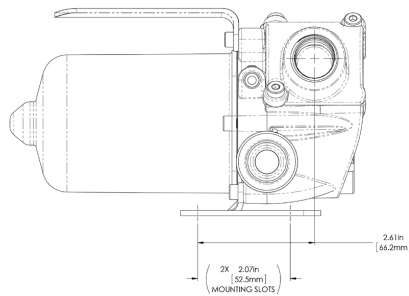
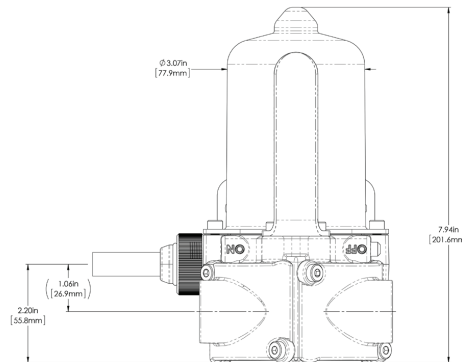

Pump	
Type - Rotary, Diaphragm, Gear, Vane	Rotary Hinged Vane
Flow Rate in supplied configuration	Up to 8 GPM / 30 LPM
GPM Open Flow - no Hose or Nozzle	Up to 10 GPM / 38 LPM
By-Pass Pressure Rating (PSI) - Max	16 PSI
Dry Vac (in Hg)	5
Head - Max (Ft.)	37
Anti-Siphon Valve	None
Inlet - Size / Thread	¾" NPT / ¾" BSPP
Outlet - Size / Thread	¾" NPT / ¾" BSPP
Mount	2" Bung NPT / BSPP
Material - Pump Housing	Aluminum
Material - Wetted Material	BUNA-N + HNBR
Rotor Material	Nylon
Rotor Vane Material	Acetal
Compatible Fluids	Diesel, Gasoline, Bio-Diesel up to B20, E15, Kerosene, Methanol (to 15%)
Strainer Mesh Size	20 x 20
Warranty	2 Years

Motor	
Power - AC 115,230, 115/230 VAC	N/A
HZ 50,60,50/60	N/A
Power - DC 12, 24, 12/24	12 VDC
HP (Horsepower) Rating	1/6 HP
Power Cord Length (feet)	10'
Power Cord Gauge (AWG)	12 AWG
DC Power Cord Connectors	NONE
Amps (FLA)	14
RPM	3600
Duty Cycle	30 min. on / 30 min. off
Thermal Protection Switch	Yes
Circuit Protection Fuse	None
Certification	UL, cUL, Motor, ATEX, CE, ANZEx



1200 SERIES PERFORMANCE CURVE

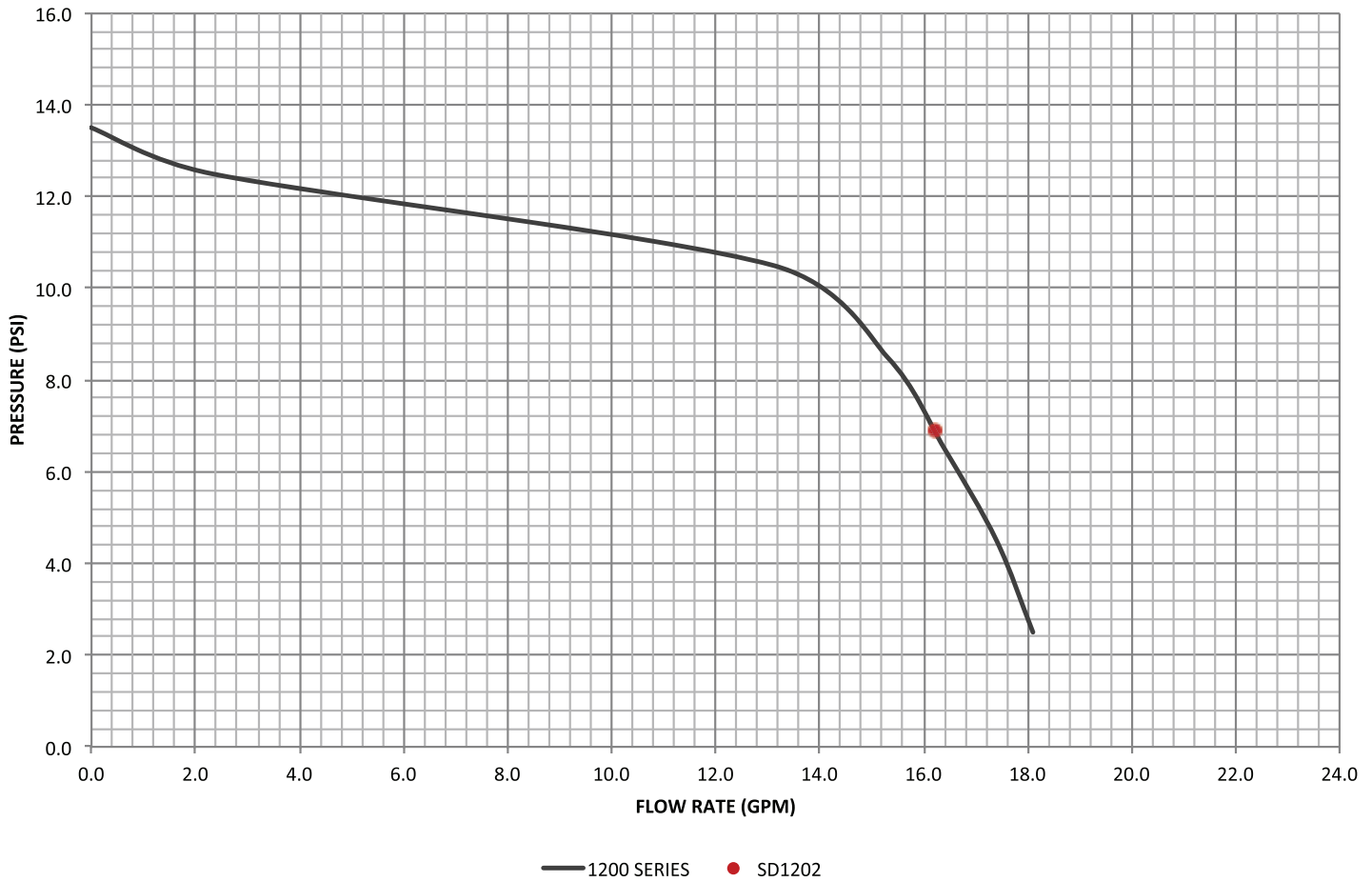

Kit	Description	Parts
KIT812PC	Power Cable Kit	Quick Connect Power Cable Assembly
KIT812RG	Rotor & Vane Kit	Rotor & Vanes, Rotor Cover, Inlet Screen, Flange O-rings, Rotor Cover O-Ring, Flange Fasteners
KIT812FL	Single Flange Kit	Flange, Inlet Screen, Flange O-Ring, Flange Fasteners
KIT812SL	Seal Kit	Inlet Screen, Flange O-rings, Rotor Cover O-Ring, Flange Fasteners, Rotor Cover Fasteners
KIT812NH	Hose Kit	3/4" x 6' Suction Hose , 3/4" x 8' Discharge Hose, PTFE Tape
KIT812NP	Bung Mount Kit	Suction Tube, Bung Adapter, Nipple, Nozzle Boot, Nozzle Boot Fasteners, PTFE Tape

Accessories	
Suction pipe material	N/A
Suction Pipe Length - Extended/Non-Extended	None
Nozzle - size	N/A
Nozzle - Manual / Automatic	N/A
Hose Liquid Materials Compatibility	Oil, Gasoline, Diesel
Hose Diameter	3/4"
Hose Length	N/A
Hose static wire (Y/N)	N/A

Logistics	
UPC	0-89404-17578-1
Length	15.5"
Width	10"
Height	6.5"